

Report of J. M. Linn
M. 560 ft from the
middle of long Jb
Hawaii Jan 202
P. 18844

I 5 4000' E
II 5 4000' E
III 5 4000' E
IV 5 4000' E
V 5 4000' E
VI 5 4000' E
VII 5 4000' E
VIII 5 4000' E
IX 5 4000' E
X 5 4000' E
XI 5 4000' E
XII 5 4000' E
XIII 5 4000' E
XIV 5 4000' E
XV 5 4000' E
XVI 5 4000' E
XVII 5 4000' E
XVIII 5 4000' E
XIX 5 4000' E
XX 5 4000' E
XXI 5 4000' E
XXII 5 4000' E
XXIII 5 4000' E
XXIV 5 4000' E
XXV 5 4000' E
XXVI 5 4000' E
XXVII 5 4000' E
XXVIII 5 4000' E
XXIX 5 4000' E
XXX 5 4000' E

TMK 4-4-13

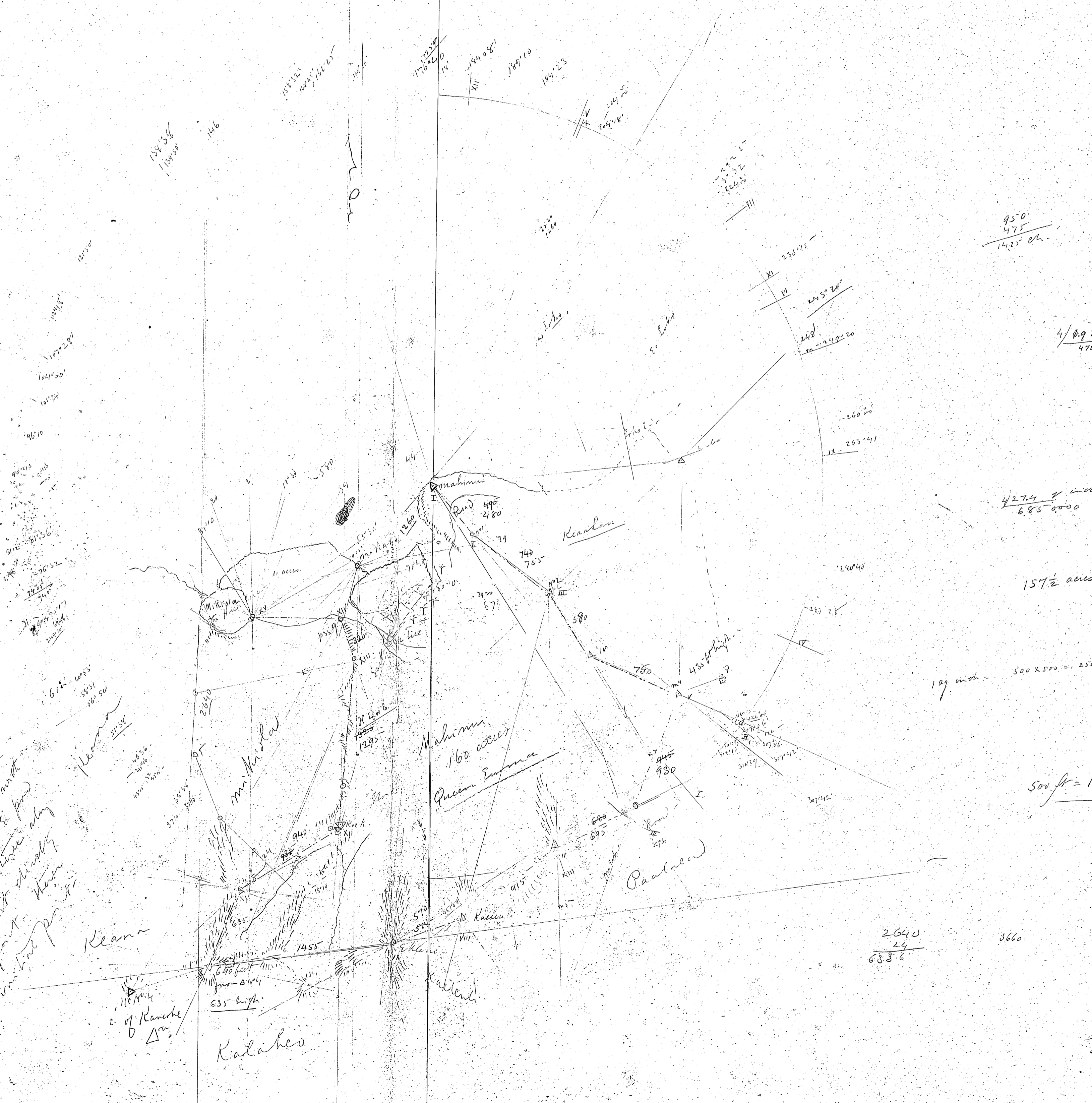

$\frac{950}{475}$
14.25' etc.

$\frac{4}{0.9 \text{ inch}}$
475 m by bar.

$\frac{427.4 \text{ inches}}$
6.85' 0.000' syft.

= 160 acres

157 1/2 acres

100 inch - 500 x 500 = 250 000 sqft.

500 ft = 1 inch

2640
340
780
1801
876
347
6350.1
48
638

828
3618
17234

MAHINU
Kaneohe
C. G. L.

HAWAIIAN GOVERNMENT SURVEY
Register No. 219
1917
7