

Zone: 4-5-57

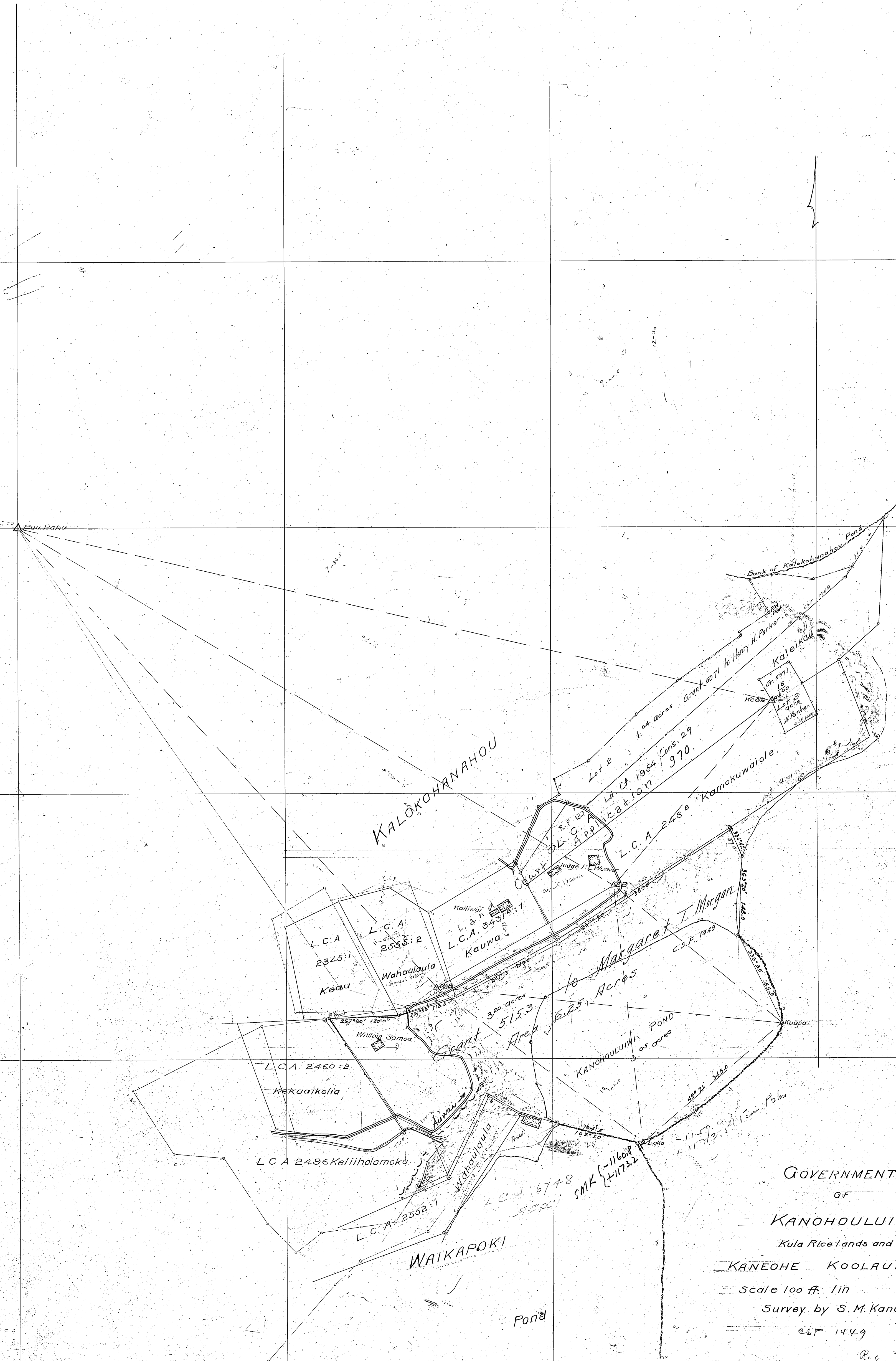

GOVERNMENT ILI
OF
KANO HOU LI WI
Kula Rice Lands and Fish Pond
KANE OHE KOOLAUPOKO OAHU
Scale 100 ft. 1 in Jan. 1904.
Survey by S. M. Kakanui
est 1449
Reg # 2223,

S. Kakanui cal. Bk 485

Reg No 2223

DP-25

F.B. G.F. Wright #701

Reg. 2223
Dr. 37(11)