

H E E I A P L A N T A T I O N

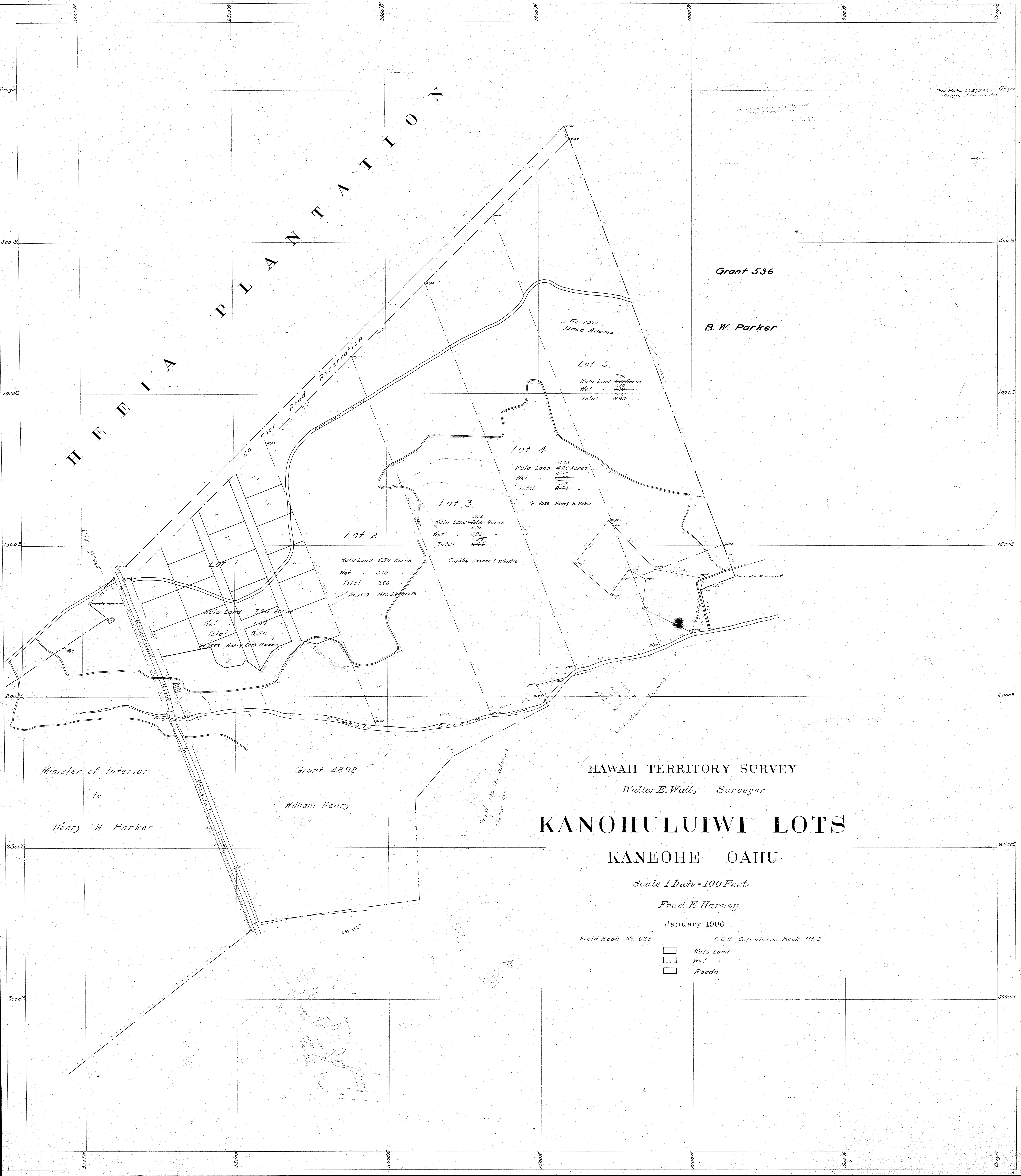

Grant 536

B. W. Parker

Gr. 7511  
Isaac Adams

Lot 5

Kula Land 7.40 Acres  
Wet 1.50  
Total 8.90

Lot 4

Kula Land 2.55 Acres  
Wet 5.15  
Total 7.70

Gr. 7516 Henry H. Parker

Lot 3

Kula Land 3.80 Acres  
Wet 5.75  
Total 9.55

Gr. 7514 Joseph I. Whittle

Lot 2

Kula Land 6.50 Acres  
Wet 3.10  
Total 9.60

Gr. 7512 Mrs. J. Warete

Lot 1

Kula Land 7.90 Acres  
Wet 1.60  
Total 9.50

Gr. 7513 Henry Cobb Adams

Minister of Interior  
to  
Henry H. Parker

Grant 4898  
William Henry

HAWAII TERRITORY SURVEY  
Walter E. Wall, Surveyor

# KANOHULUIWI LOTS

## KANEOHE OAHU

Scale 1 Inch = 100 Feet

Fred E. Harvey

January 1906

Field Book No. 625

F. E. H. Calculation Book No. 2.

- Kula Land
- Wet
- Roads